

Moonta historic pub-crawl



George Street, Moonta, looking north-west, with Moonta Hotel on the left, c 1933 [SLSA B 8740]

1 Moonta Hotel

Oldest hotel in Moonta, licensed 14 September 1863. In 1910 included nine bedrooms; patronised by farmers and miners. "A homely house, well conducted."

Moonta Hotel c.1873 [SLSA B 26971]



2 Cornwall Hotel

Known initially as the Globe Inn/Hotel (1865-1958). First licensed in 1865. Destroyed by fire and rebuilt in 1889. Wide verandahs added in March 1910.

Globe Hotel [Cornwall Hotel] c.1927 [SLSA B 33803]



Globe Hotel [Cornwall Hotel] c.1890 [SLSA B 22865]

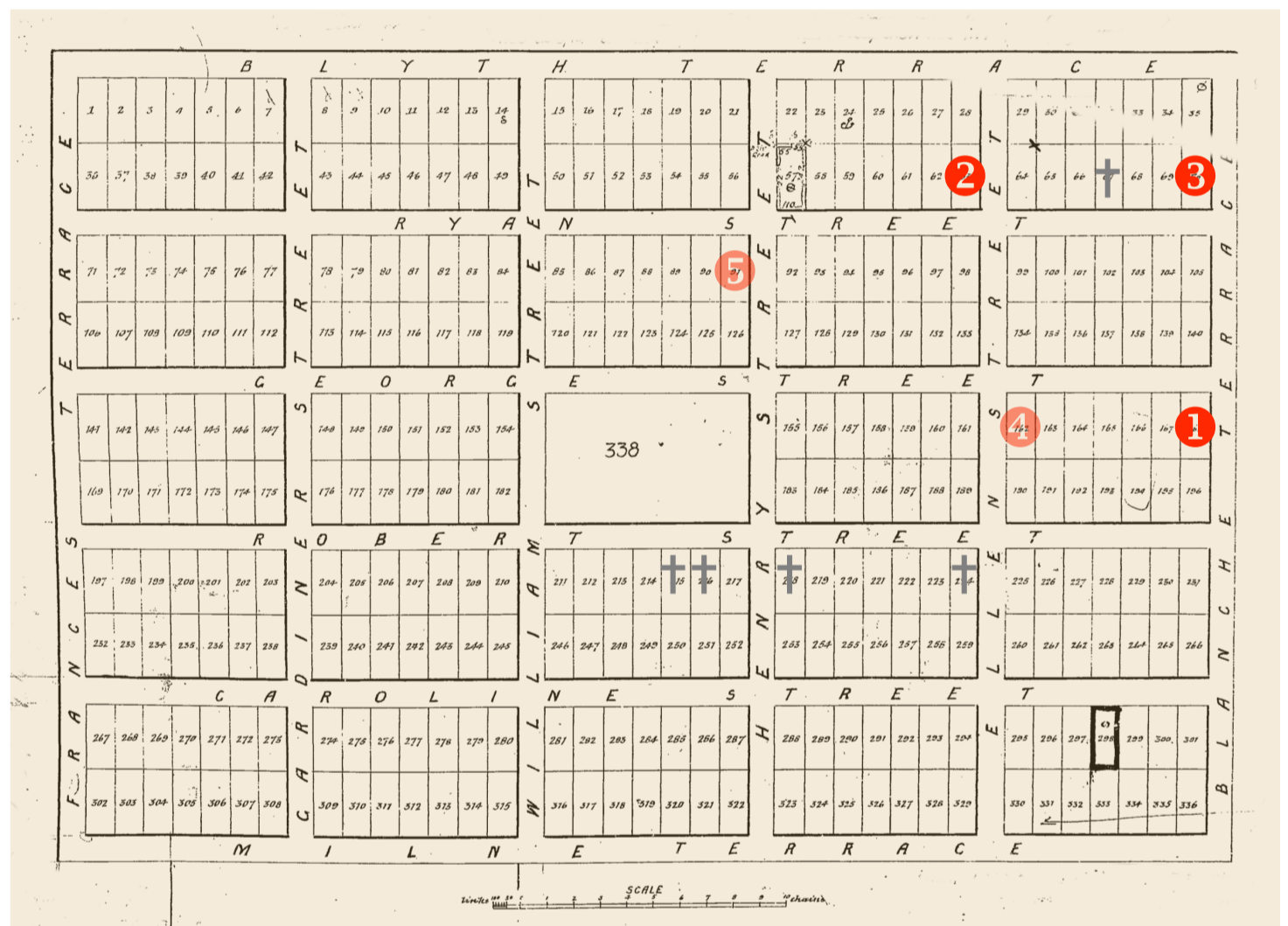

3 Royal Hotel

First licensed in 1865. Closest pub to railway station. 'Sample rooms' added in 1896 for commercial travellers. Verandahs added in 1912.

Royal Hotel c.1896 [SLSA B 21224]



4 Prince of Wales Hotel

Also licensed 14 September 1863. Delicensed as a result of the Local Option poll in 1910, became "Moonta Temperance Hotel".

Prince of Wales Hotel c.1883 [SLSA B 9720]



5 Miner's Arms Hotel

First licensed in 1865, de-licensed as a result of the Local Option poll in 1910 and fell into disrepair. Demolished in March 1924.